

Data Sheet

VHX Valve Sets with RTX Temperature Limiter for Designer Radiators & Bathroom Towel Rails

Application



VHX floor connection



VHX wall connection

The VHX-sets are specially designed for towel rails and designer radiators with '50 mm bottom connection' and '1/2" connection to the radiator. The VHX-sets include a RTX temperature limiter for regulation of the return flow temperature.

VHX valves controls the return flow from the radiator and have several features:

- free choice of left/right mounting direction
- available in versions for floor or wall connection

- built-in shut-off function
- four different surfaces matching most radiators

The VHX sets provides the perfect finishing touch for towel rails. The aesthetically pleasing and compact design allows the sensor to be mounted underneath the towel rail, parallel with the wall.

Ordering

VHX set

Description	Colour	Code no. Straight	Code no. Angle
VHX-DUO valve set, with RTX return flow sensor	Chrome	013G4376	DANDUOC
	RAL 9016	013G4378	DANDUOW
VHX-MONO valve set, with RTX return flow sensor	Chrome	DANMONSC	DANMONC
	RAL 9016	013G4384	013G4387

Compression fittings

Description	Size	Code no. Nickel plated	Code no. Chrome plated
For steel and copper tubes	8 mm	013G4108	-
	10 mm	013G4110	013G4192
	12 mm	013G4112	013G4193
	14 mm	013G4114	013G4194
	15 mm	013G4115	013G4195
	16 mm	013G4116	013G4196
For AluPex tubes	12 x 2 mm	013G4172	-
	14 x 2 mm	013G4174	-
	16 x 2 mm	013G4176	013G4200
For Pex tubes	12 x 1.1 mm	013G4143	013G4197
	12 x 2 mm	013G4142	-
	14 x 2 mm	013G4144	-
	15 x 2.5 mm	013G4147	013G4199
	16 x 2 mm	013G4146	013G4198

Accessories

Product	Code no.
Electric heating element - 47 cm - 300 W - 1.2 m w/ Schuko plug ¹⁾	013G4167
Electric heating element - 40 cm - 150 W - 1.2 m w/ Schuko plug ¹⁾	013G4168
Electric heating element - 70 cm - 600 W - 1.2 m w/ Schuko plug ¹⁾	013G4169
Adapter for electric heating element	013G4166
O-ring service set for VHX MONO angle valve and VHX DUO angle valve ²⁾	013G4179
O-ring service set for VHX DUO straight valve	013G4180
O-ring service set for VHX MONO straight valve	013G4181

¹⁾ Electric heating elements are according to the standard UNEL 47168/68-CEE (7) xvll.

²⁾ Complete O-ring replacement of VHX DUO angle valve requires 2 x 013G4179.

Technical Data

Type	Connection		P-band	k _v -values [m ³ /h] with RAX sensor at setting ¹⁾								(k _{vs}) N
	Rad.	Sys.		1	2	3	4	5	6	7	N	
VHX-DUO	G½A	G½	2K	0.12	0.14	0.16	0.17	0.18	0.19	0.20	0.21	0.56
			5K	0.16	0.19	0.22	0.25	0.29	0.33	0.37	0.41	
VHX-MONO	G½A	G½	2K	0.12	0.14	0.16	0.17	0.18	0.19	0.20	0.21	0.45
			5K	0.16	0.19	0.22	0.25	0.29	0.33	0.37	0.41	

Max. work. pressure: 10 bar, max. diff. pressure²⁾: 0,6 bar, test pressure 16 bar, max. flow temp.: 120 °C

¹⁾ The k_v-value indicates the water flow (Q) in m³/h at a pressure drop (Δp) across the valve of 1 bar; $k_v = \frac{Q}{\sqrt{\Delta p}}$. The k_{vs}-value states the flow Q at a maximum lift, i.e. at fully open valve at setting N.

²⁾ The maximum differential pressure specified is the maximum pressure at which the valves give satisfactory regulation. As with any device which imposes a pressure drop in the system, noise may occur under certain flow/pressure conditions. The differential pressure can be reduced by the use of the Danfoss differential pressure regulators.

RTX has - due to its mode of operation - a very limited influence on the hydraulic balance of the heating system.

Changing the k_v-setting from "N" (factory setting) is therefore seldom required.

Temperature Setting

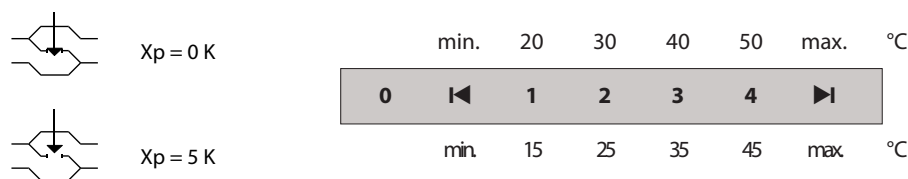

At position 0 the valve is totally closed, i.e. the frost protection is off.

Pre-Setting

Danfoss pre-settable valve assemblies incorporate easy setting adjustment with clearly engraved setting markers scaled from 1 - 7 and N. Setting values can be set quickly and precisely, without the need for tools, as follows:

- Remove protective cap or sensor.
- Turn Red ring to the desired setting value.

The preset level can be selected in 0.5 increments between 1 and 7 (see chart for flow rates). At setting N the valve is fully open (flushing option).



Installation

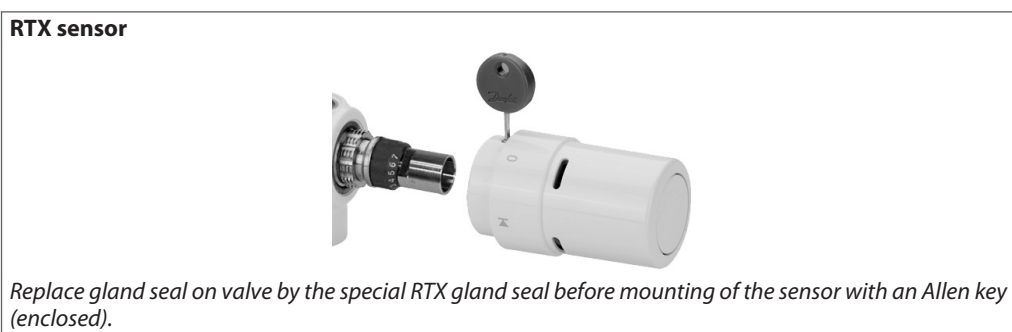
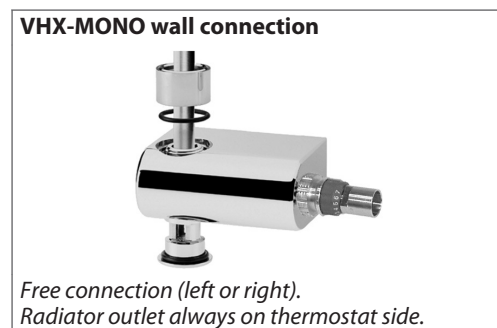
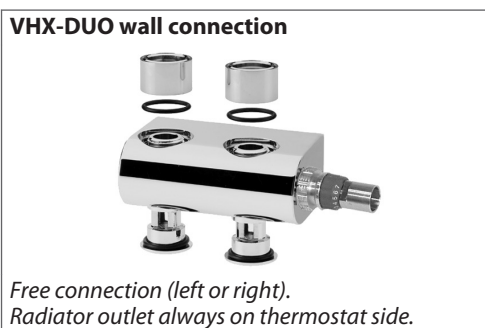
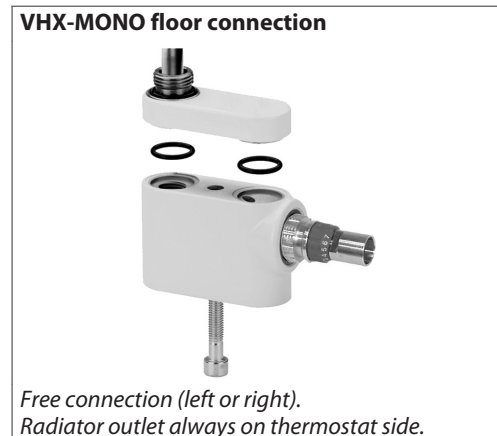
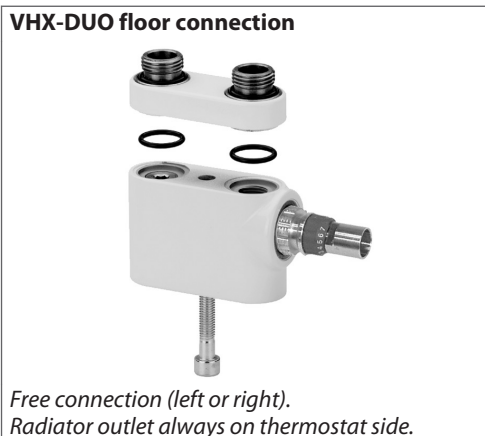

Electric Heating Element

Danfoss electric heating elements can be mounted in the radiator through the VHX-DUO angle valve. Mounting of a standard heating element (non-Danfoss) through the valve requires use of the adapter 013G4166.

If a heating element is to be used with other VHX valves, a standard heating element (non-Danfoss) has to be mounted directly in the radiator.

Examples: Mounting of an electric heating element

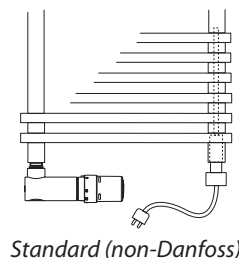
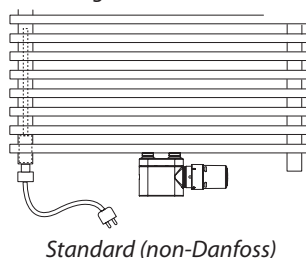
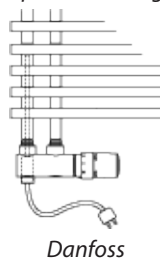

Dimensions

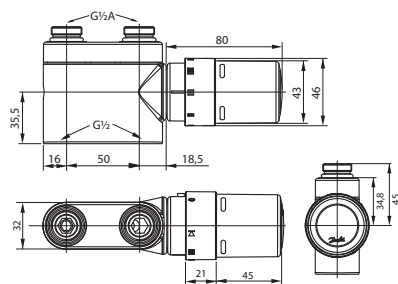

VHX-DUO floor connection

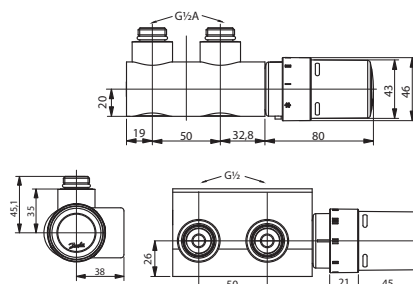

VHX-DUO wall connection

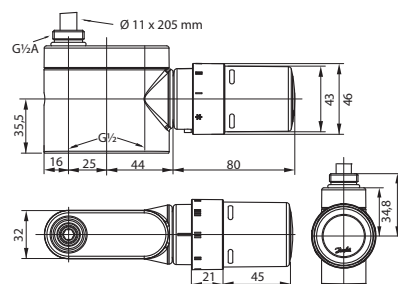

VHX-MONO floor connection

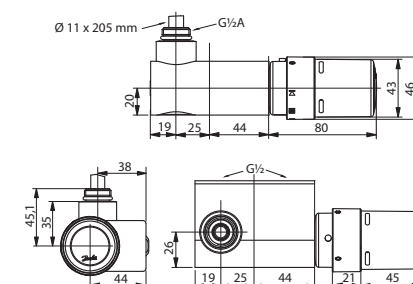

VHX-MONO wall connection

Danfoss A/S
 Heating Solutions
 Haarupvaenget 11
 8600 Silkeborg
 Denmark
 Phone: +45 7488 8000
 Fax: +45 7488 8100
 Email: heating.solutions@danfoss.com
 www.heating.danfoss.com

Danfoss can accept no responsibility for possible errors in catalogues, brochures and other printed material. Danfoss reserves the right to alter its products without notice. This also applies to products already on order provided that such alterations can be made without subsequential changes being necessary in specifications already agreed. All trademarks in this material are property of the respective companies. Danfoss Heating Solutions and the Danfoss Heating Solutions logotype are trademarks of Danfoss A/S. All rights reserved.